



Tomberlin ENGAGE

New Features, Functions & Benefits



Introduction

The Tomberlin E-MERGE has consistently offered more features, functions and benefits (FFBs) than any competitive golf cart, Personal Transportation Vehicle (PTV) or Low Speed Vehicle (LSV) in the market. For the new Engage we decided to push ourselves further by finding new ways to fulfill customer-driven demands. The new Tomberlin ENGAGE exemplifies our commitment to deliver best-in-class safety, performance and style.

Our design began with proven foundation of the E-MERGE—including the chassis, braking system, and drivetrain. We then designed a sleeker body, created a new dashboard and improved ergonomics with new controls, switches, and features including an industry first heat and ventilation system for an automotive experience. Furthermore we incorporated new front and rear lighting along with an exclusive patented lighted rocker panels system for increased style and safety.

This document will educate you on all of the new features and details of the new ENGAGE.

The following table lists the new or enhanced ENGAGE features (compared to the E-MERGE).

| Feature | Safety | Performance | Style |
|---|--------|-------------|-------|
| Automotive Body Styling | | | X |
| Windshield Enhancements | X | | X |
| Ergonomic Dashboard | X | | X |
| 7-Inch LCD Speedometer (in line of sight) | X | | X |
| 7-Inch Touch Infotainment Center | | X | X |
| Wireless Cell Phone Charger | X | | X |
| 4 Cup Holders (easily removed and cleaned) | | | X |
| Locking Glove Box with Expanded Space | | X | X |
| In Dash Heat and Ventilation System | X | X | X |
| 2 Automotive style vehicle control stalks for improved ergonomics | X | X | X |
| New Dashboard Switches, Ports & Microphone | X | X | X |
| Additional Storage Areas | X | X | X |
| Umbrella | X | | X |
| Enhanced Windshield Wiper controls | X | | X |
| New Rearview Mirror | X | | |
| Dual Automotive Style Side Mirrors w/Indicators (and gimble design) | X | | X |
| Sleek Multifunction LED Headlights | X | | X |
| Lighted Tomberlin Logo | X | | X |
| Sleek Multifunction Tail Lights with Reverse Lights | X | | X |
| Lighted Rocker Panel | X | | X |
| Locking Storage Trunk with 2 Means of Entry | | X | X |
| Rear Bumper | X | | X |
| New Canopy | | | X |
| New Rear Camera | X | X | |
| Enhanced Headliner with new dome light controls and lighting | | | X |
| Enhanced Rear-Facing Seat | X | X | X |

Each of the above new ENGAGE features are described in more detail below.

New Automotive Body Styling

We wanted to keep the successful DNA of the Tomberlin E-MERGE, but we pushed ourselves to create a style that reflects cutting edge style, and a thrilling drive. We kept the trademark front grill; but as you look closely at the ENGAGE—from the front to the rear and everything in-between—you will see modern lines, contours and shapes that exemplify a differentiated and artful style. The automotive look is aggressive with raised shoulders and a center power bulge on the front hood. There's an integrated spoiler designed into the rear trunk lid, and a new illuminated front logo. We integrated the windshield and dashboard together to enhance the stylistic lines. The dashboard exemplifies an intelligent ergonomic waterfall design; and extends the lines, contours and shapes from the body. For example, the shoulders of the vehicle carry into the sides of the dashboard. The design of the front fenders carries through into the design of the seats. Even the stitching on the Cool Touch Seats mimics the front body lines.

Windshield Enhancements

We changed the design of the front windshield to integrate more effectively with the dash. In addition, to make it easier for the occupants to reach dashboard switches, storage areas, air vents, and so forth, we changed the angle (or rake) of the windshield to move it forward giving more headroom.

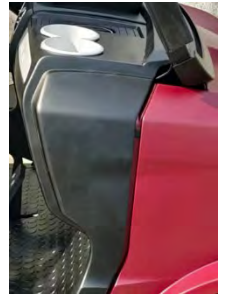

New Ergonomic Dashboard

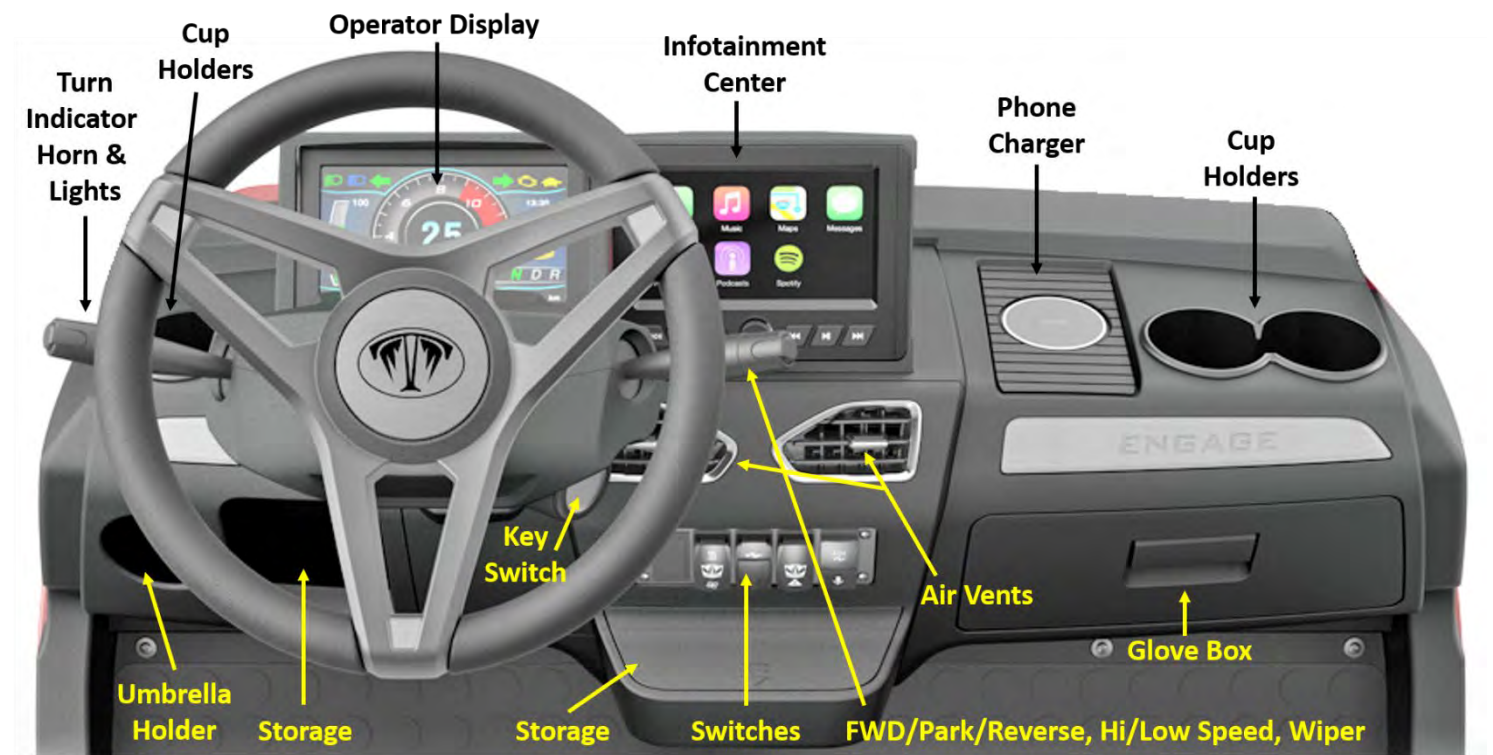

The ENGAGE dashboard was ergonomically designed to make it easier and safer to operate the vehicle. Each of the enhancements are described below starting with the Operator Display and then working in a clockwise rotation around the dashboard graphic.

7-Inch Operator Display

The operator display was moved directly behind the steering wheel and in the line of sight when driving. This position also provided space for the Infotainment Center.

New 7-Inch Color Touch Infotainment Center (Option)

The 7-inch color touch screen:

- Supports Apple CarPlay and Android Auto. Allowing the customer to answer phone calls, texts or use Google Map Navigation while driving.
- Plays AM / FM radio, and music from a USB memory stick.
- Supports Bluetooth (Plays music from a Bluetooth device).
- Supports MP3/MP4 audio.
- Easy to set radio stations and sound volume zones.
- Has an IP66 rating.



If not configured, a dashboard insert is mounted to provide additional storage.

New Wireless Cell Phone Charger

A market first, the wireless phone charger has a rubber mat and a slight downward angle to minimize phone slippage.



New Aux (Auxiliary input and microphone) Ports

The new Aux port allows the phone to charge while operating Apple Car Play or Android auto. The included microphone allows for phone calls while driving.

New Cup Holders

There are 4 cupholders that are wide enough for a YETI®- style cup: 2 for the passenger and 2 for the driver. In addition, each cup holder has a drain hole, snaps out for cleaning, and securely snaps back into the dashboard.

New Larger Locking Glove Box

The storage area of the glove box has been expanded (12 x 10 x 5-inches in volume). The glove box key is the same used to unlock the trunk.



New Air Vents, Fan, Heater & Switch



Adjusting the air flow of the new air vents is similar to adjusting automotive air vents. You may turn the direction of the air flow left to right, up or down by the tab on the air vent. We also added an air vent fan, heater and dash-mounted switch which performs 2 separate functions. First, the fan “pulls” outside air into the cab when the switch is pushed downward. Second, the fan will push

electric heated air into the cab when the switch is pushed upward.



New Operational Controls on Multi-Function Sticks

Fingertip operator controls are within easy reach via 2 multifunction stalks directly behind the steering wheel. This new design is more automotive and ergonomic compared to dash mounted direction controls or rocker switches.

Left stalk: turn indication, horn, & headlights.



Right stalk: forward/reverse, high/low speed, & wiper

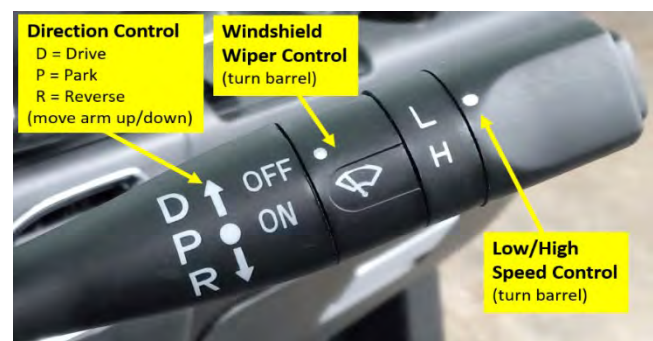

New Dashboard Switches, Ports & Microphone



The open switch location is for future functionality. The fan switch is described above. The dual USB charger (in the center) provides power to charge USB devices such as your phone. The emergency switch causes all turn indicators (front and rear) to continuously flash (like the emergency switch

on your automobile). The Aux (auxiliary) Charge Phone I/F and microphone port (on the right) provides multiple functions. First, it also provides USB charging functionality. But what's more, it also provides a USB phone connection for Apple CarPlay and Android Auto. The microphone port provides a means to connect the included "microphone bud" with an anti-wind foam cover for hands free phone communication.



New Additional Storage Areas

We added 3 additional storage areas. The center storage area is protected by a pop open lid: press the lid to open and press to close. A second storage area is located below and to the left of the steering wheel. The third storage area on the left side of the dashboard is designed to hold the Tomberlin ENGAGE umbrella.



New Umbrella

Every ENGAGE includes a market first: an umbrella stored in the dashboard for easy reach and deployment as you exit the vehicle.



Enhanced Windshield Wiper

To provide additional head space when entering the cab, we moved the wiper on/off switch to the right multi-function stalk.



New Side Mirrors



We improved the side mirrors to function similar to automotive side mirrors. For example, they have a gimble design that allows manual adjustment of the mirrors up, down, left, and right. And, to reduce the chance of damage, the side mirrors have a breakaway function (will turn inward when pushed). We also improved the design and strength of the side mirror bracket to reduce wiggling and movement.

New External Lighting

We made enhancements to the front lights, Tomberlin logo, rocker panels, and rear lights.

The front LED lights provide multiple functions:

1. Daytime run lights (when ignition key is turned on for safety).
2. Daytime run lights change color and flash for turn indication/emergency.
3. Headlights with low and high beam.



The Tomberlin logo (mounted on the front cowling) is illuminated when the vehicle's light switch is turned to the 1st or 2nd position.

In addition, when the light switch is turned to the 1st or 2nd position, the rocker panel light bars initially display a rainbow of flowing colors, and then transition to bright white. These lights greatly enhance safety by increasing the ability of oncoming drivers to recognize the vehicle's presence from the side.



The rear lights provide multiple functions (as depicted below). They will emit a:

1. Reddish light when the headlights are turned on.
2. Darker red light when the brake pedal is depressed.
3. New reverse light when the vehicle is in reverse to improve visibility at nighttime.
4. Amber light when the turn inductor is selected.



New Trunk

There are two means to gain access to the locked trunk (using the same key for the locking glove box). The first means is to unlock and open the entire trunk lid for full access to the trunk area. In addition, the trunk lid may be easily removed to facilitate room for golf bags and other items by (1) unclipping the 2 cables, and (2) lifting the trunk lid to disengage the lower curved brackets. The second means to access the trunk area is by unlocking and opening the rear-facing door. This means is used when full access is not required, or if a rear facing seat is installed.



New Rear Bumper

We added improvements to the rear bumper. First, we inset the bumper into the rear frame—similar to an automotive style bumper—which adds to the overall sleek design. Second, the bumper has a support bar behind it—which is easily removed and replaced if damaged. Third, we also embedded the two rear reflectors into the rear bumper (indicated by the arrows). These reflectors improve safety because they assist an approaching driver at night to recognize the ENGAGE when it is parked and lights are turned off.



New Canopy



The sleek design of the new canopy mimics the lines of the body. Plus, the new canopy is designed to protect occupants by moving water to the front of the car and in front of the windshield. In addition, while the car is in motion, the water will move to the outside corners of the canopy and away from the occupants. The trailing edge of the canopy is also designed to more effectively accommodate the rear camera.

The mounting of the headliner has also been improved via side mounted bolts—which improves the connection strength between the pillars and the canopy, and minimizes the chance of a rattle.

New Rear Camera

The rear camera is integrated into the roof-mounted brake light—thereby providing a sleeker and less obtrusive design.



New Enhanced Headliner

The headliner is designed to seamlessly integrate with the new canopy.



In the front of the headliner and above the rearview mirror are 4 switches (from left to right): Accent Light, Camp Light, T Logo Light, and Mode.



The Accent/Map Light switch provides lighting for the front of the cab. The 2 bright LED accent/map lights replace the single light that was mounted above the rearview mirror on the E-MERGE.



The Camp Light switch provides bright strip lighting for the rear of the vehicle—in lieu of the 2 rear lights on the E-MERGE.



The third switch from the left turns the T logo light on or off.

We have replaced the remote control which can become lost or damaged and replaced it with new On/Off and Mode switches. The Mode switch toggles how the T logo is illuminated. For example, you may select different colors which may be illuminated as solid, fade, and flicker. (+) advances to the next illumination option, (-) selects the previous option.

New Headliner Rearview Mirror

The rearview mirror may be tilted up or down, left or right.



New Enhanced Rear-Facing Seat

Columbia Vehicle Group, Inc.

A Nordic Group Company | Business Ventures Since 1947

www.TomberlinUSA.com



COLUMBIA



TOMBERLIN